

C330V



WE'RE OFF TO
FOLLOW THE SUN

SEALINE C330V



SEALINE C330v

SEALINE: THE YACHT THAT HAS IT ALL

TEAK PLATFORM ON EACH SIDE

Two swimming platforms have been placed around the outboards to ensure everyone goes in and out the water easily.

DYNAMIC HULL DESIGN

The sculptured hull provides excellent performance whilst giving light and space to the interior.

FUN-TO-DRIVE OUTBOARDS

Driving the C330v is spontaneous and entertaining. And with quieter outboards, life on board is sure to be a pleasure.

BIFOLD DOOR & TILTING WINDOW

In the aft you can blur the line between inside and outside: open the bifold door and the tilting window to the cockpit bar.

TWO OPENING ROOF SECTIONS

Maximum versatility and comfort for the guests. Shade and sun where you need them.

TWO GENEROUS SUN LOUNGES

Sunbathing for all your guests. In addition to the sunbed at the bow the rear settee can be transformed into a comfortable lounge.



FEELS LIKE JOY AT FIRST SIGHT

The new Sealine C330v combines the intelligent all-weather design of the Sealine Cruiser series with the agility of two outboards. Rediscover the feeling of spontaneity and independence on this yacht!

Escape the everyday to any point of the compass: The C330v was created to cruise the world's best waters – whether in the Tropics or high latitudes. A sporty performance, spacious cabins and a well-sheltered living space on deck make the C330v a perfect hideaway throughout the entire year.





All Sealine yachts are born of the same values: they feature wide interior spaces, an amazing quantity of natural light and outstanding design with German engineering inside. As for these trademarks, the C330v displays the true spirit of Sealine.



enjoy the
LIGHT

feel the
SPACE

combine functionality with
DESIGN



EVERY SQUARE INCH IS DEDICATED TO PURE RECREATION

On the Sealine C330v you experience many facets of freedom. Two sun decks, one forward and one aft, invite you to relax. Extra-large sunbeds can be placed in the bow section. Aboard this cruiser, the sun shines for everyone.



The Sealine C330v shows its versatility in two simple steps: fold the sliding door to one side and open the window to the cockpit. This way you create a seamless, open space with the cockpit bar at the centre. Here you can present fresh snacks and drinks in an irresistibly inviting way.



The C330v combines bathing pleasure with outboard technology. A bathing platform with luxury teak decking can be found on both the starboard and port sides behind the cockpit. The floor beneath the aft table folds upwards to provide plenty of storage space for anything that makes swimming or diving more enjoyable.



SEALINE C330v



TAKE A SEAT – AND THEN TAKE OFF

One of Sealine's trademarks is to arrange the instruments in a way that brings ergonomics and style into perfect balance. The helm station is a designer piece in itself, adding a spectacular touch to the space with its gleaming chrome fittings.



At any time, the twin outboards are ready to enrich your on board life with action-packed moments. Offering 2 x 300 hp, the Sealine C330v easily accelerates to a speed of up to 40 knots. Outstanding handling characteristics are part of the Sealine experience, too. From the hull shape to the engines, we have pulled out all the stops to ensure you will experience exhilarating moments at sea.



SEALINE C330v



WHEN YOUR STYLE AND THE SEA OUTSHINE EACH OTHER

At a length of 33 feet, the C330v offers many sociable and cosy areas. Due to the recessed superstructure, guests enjoy open views to the sea while seated. As with all Sealine motor yachts, the interior also invites you to explore its impeccable amenities. High-quality finish and great attention to detail is evident from every angle. Rich materials are found throughout, including leather and stainless steel. As a special feature, you can lower the saloon table, pad it with cushions and create a generous area for reclining.



The interior of the Sealine C330v brings elegance, luxury and volume into perfect balance. The two double cabins set the benchmark of what is currently possible in the 33 ft category in terms of headroom and bed size. Once inside, you realise why light switches are rarely used on this boat before sunset. Large hull windows provide abundant natural light – as well as wonderful, near-panoramic views. Additional skylights fill the rooms with even more daylight from above.



BOAT MONITOR*

- | | | | | | |
|---------------------------------------|------------------------------------|---|--|---|---|
| FRIDGE
Turn on/off remotely | LIGHTS
Turn on/off | HATCH/DOOR SENSOR
Monitor unauthorised access | SHORE POWER
Monitor connection | ENGINE
Monitor activity | MOTION SENSOR
Collision and grounding detection |
| FUEL TANK
Monitor level | WATER TANK
Monitor level | BATTERY BANK
Monitor level | GPS, WIND AND SPEED DATA | ANCHOR WINCH
Monitor activity | BOW THRUSTER
Monitor activity |
| | | | | BILGE PUMP
Monitor activity | |

*Control and sensors depend on the configuration of your Sealine.

MY SEALINE SAFETY CLOUD

YOUR ENTIRE YACHT IN YOUR HAND

Everyone is talking about the digital future. But Sealine is implementing it – with the first cloud-based telematics system for series production motor yachts. You can access your boat's technical data and functions live via the mobile app or via the owner's area at www.sealine.com

Intelligent functions such as BoatMonitoring, eLogbook and eServicebook enable you to keep an automatic logbook, stay on top of all servicing dates and monitor your yacht seamlessly.

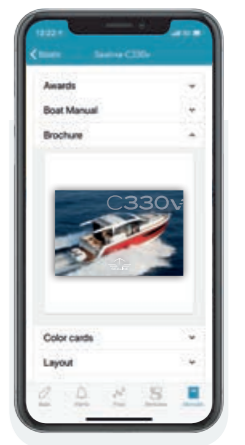

MANUALS

All manuals and instructions within one app.

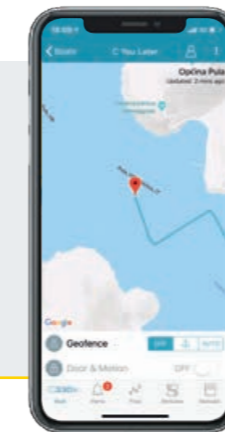

POSITION

Track your position in real time.

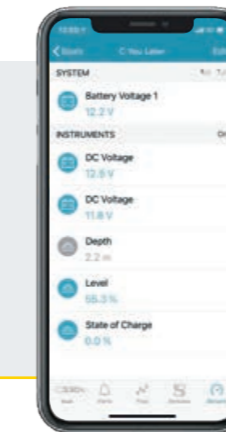

SENSORS

Monitor your charge levels and devices.

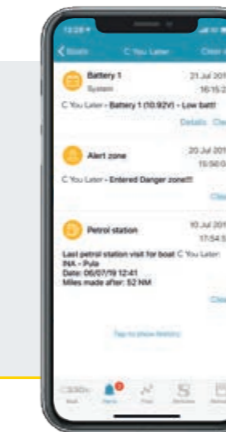

ALARMS

Push notifications on current events.

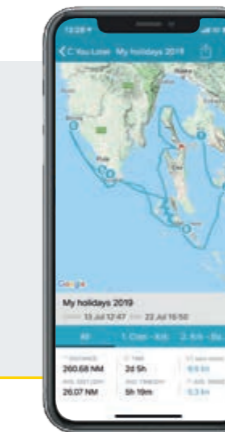

TRIP LOG

Share your cruises and track data with friends.

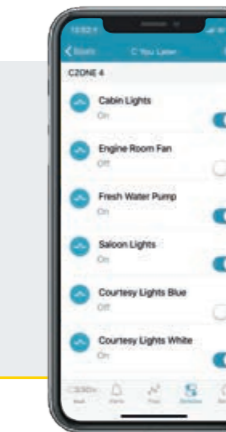

CONTROL

Operate your electronic devices by remote control.

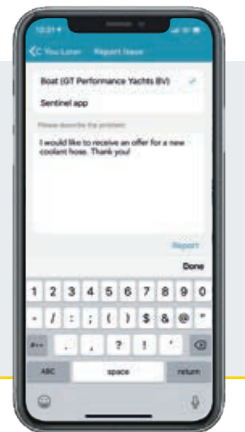

LIVE REPORT

Direct contact to your dealer for quick help.

BORN TO PERFORM



POWERED BY 2 X 300 HP

Because outboards release all their power in the exact direction you steer, they are very agile and great fun to drive. Being able to lift the entire motor out of the water also makes maintenance very easy.



UPRIGHT STEM

The vertical bow with its curved foot pierces the waves elegantly and efficiently. This, in turn, results in more comfort and more boating pleasure.

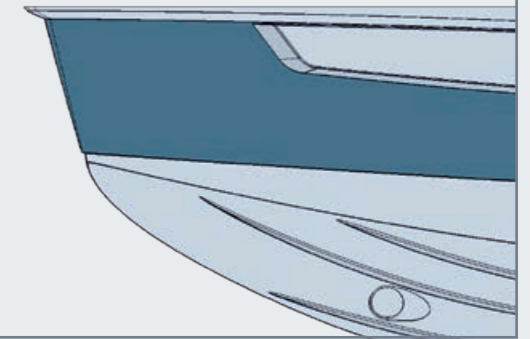

LAMINATED POWER GRID

The hull reinforcements of the Sealine C330v are elaborately laminated – giving you the advantages of a high-strength yacht with a reduced weight.

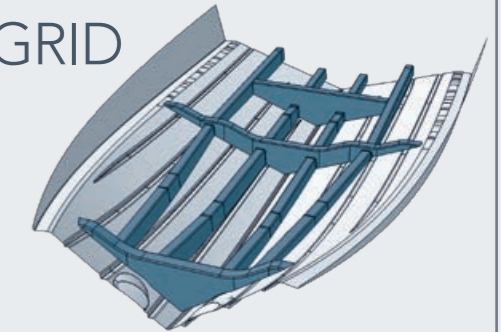

DEEP V-SHAPED KEEL

The Sealine C330v hull has a deep-V shape. This means the Sealine is exceptionally stable in the water, making for more comfortable boating.

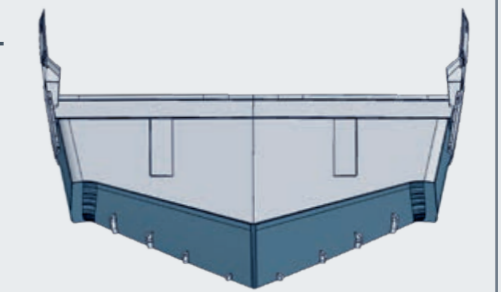

SEALINE C330v

PRINCIPAL DIMENSIONS according to ISO 8666

LOA	10.31 m	33' 10"
LOA ext. platform	11.01 m	36' 1"
LH	10.07 m	33' 0"
Beam	3.50 m	11' 6"
Draught double engine	0.89 m	2' 11"
Height above waterline inc. mast	3.48 m	11' 5"
Height above waterline excl. mast	2.80 m	9' 2"
Fuel capacity	570 l	125 UK gal
Water capacity	220 l	48 UK gal
Displacement approx.	7.27 t	7.16 UK t
Max. people on board	8	8
CE Category	B	B

Max. outboard horse power allowed	2x300 hp	Your dealer will advise you
Max. speed allowed	40 knots	



TECHNICAL DETAILS & LAYOUTS

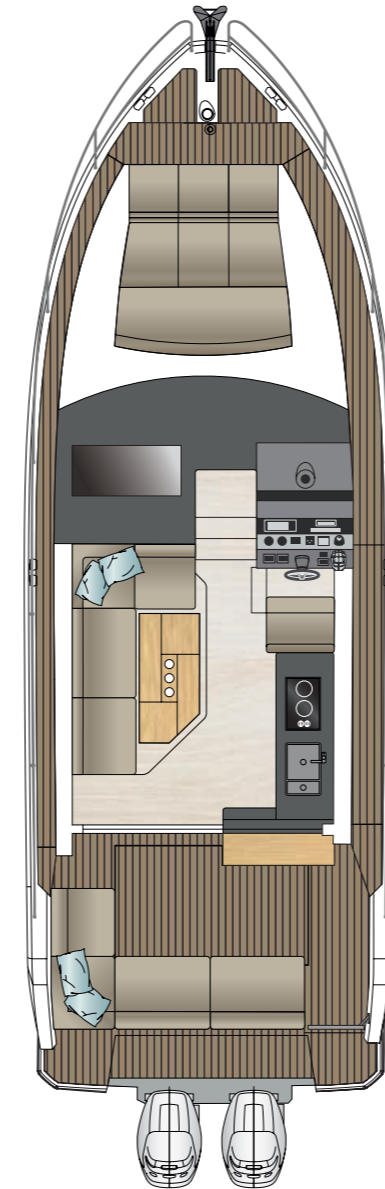

MAINDECK

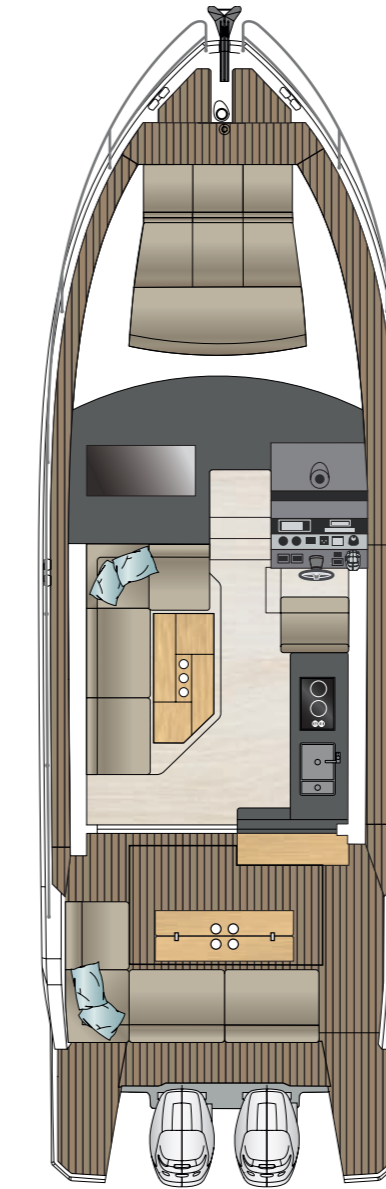

MAINDECK
option

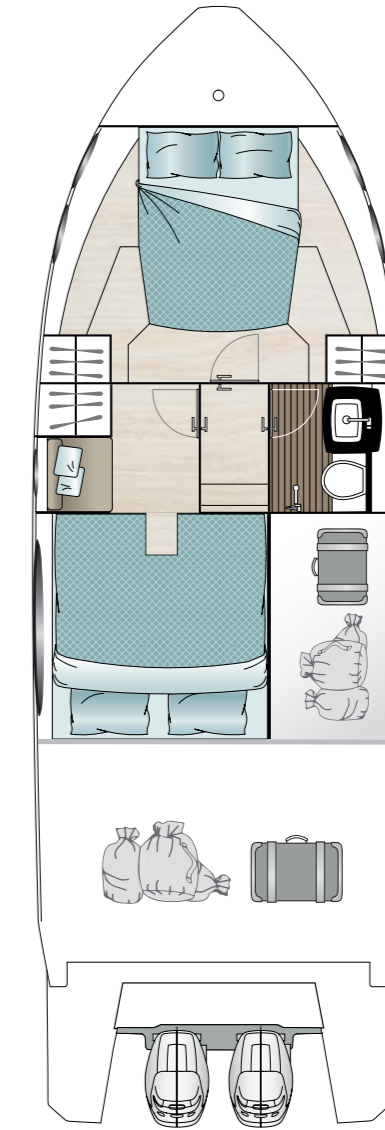

LOWERDECK

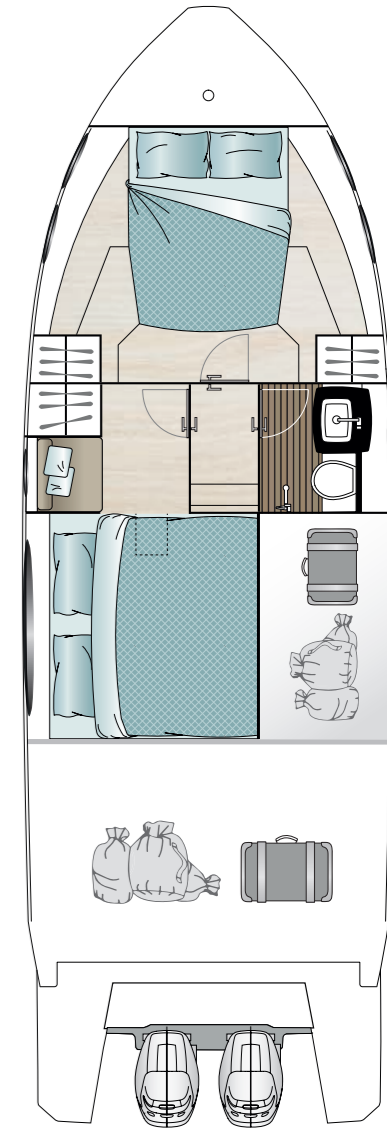

LOWERDECK
option

* All performance figures are given in good faith and are intended as an indication. These figures cannot be guaranteed as top speed in particular is affected by the cleanliness of the hull, conditions of the propellers, weight carried and air/sea temperature. Performance is related also to the optional accessories selected. SEALINE reserves the right to change specifications in line with the company policy of improvement through research and development. Errors and omissions expected. Please check with your dealer for a full list of inclusions. This brochure is not contractual. The yachts depicted partly comprise special equipment not included in the standard scope of supply. Illustrations may not correspond with current versions. Subject to alterations in design and equipment without notice and errors excepted. Artwork: smz, Print: EggersDruck. Photos: Nico Krauss.



LIMITLESS VARIETY

MATCHLESS QUALITY

The manufacturing quality of the Sealine C330v is a multi-sensory experience. Exquisite materials spoil the eye with every glance. A subtle scent of finest leathers blends with the pleasing feel of elegant woods. Anything you see or touch was masterfully handcrafted by superb boat builders. Enjoy an exclusive atmosphere that can only be created by the perfect match of sophisticated details.

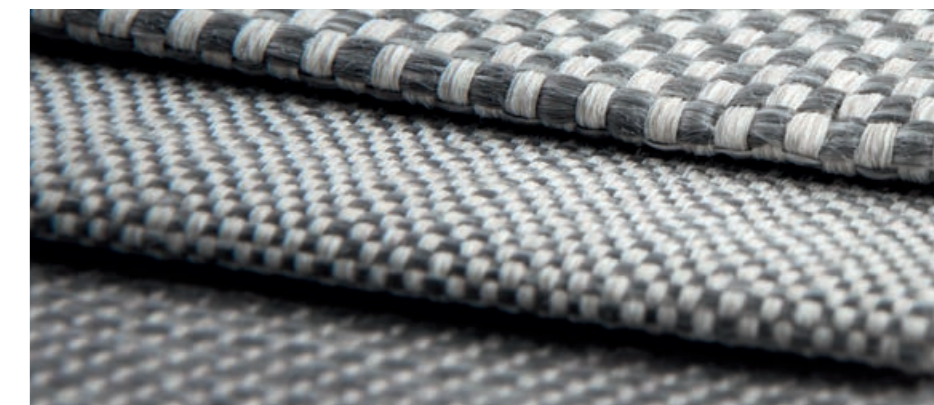
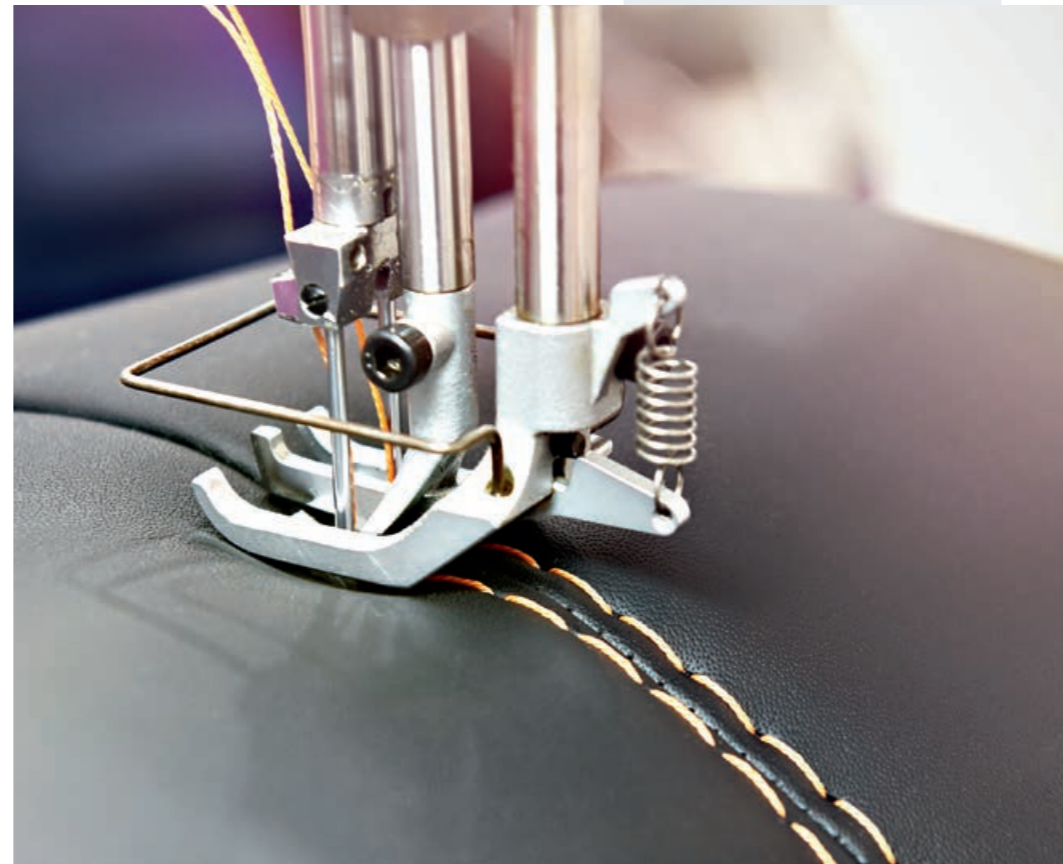

EACH SEALINE IS ONE OF A KIND

With your personal selection of colours and textures, you transform your Sealine into a unique expression. Five teak variants are available for the deck alone. We also offer special materials for cockpit seats and sun cushions. For the interior you can choose between different furniture woods, upholstery and curtains, while underfoot, select from wood or carpet.



GERMAN PRECISION AND PASSION FOR THE SEA. THAT'S WHAT A SEALINE IS MADE OF.

In 2013, the Sealine brand found a worthy new home on the German Baltic coast. At our shipyard in Greifswald, we have perfected the interplay between state-of-the-art manufacturing techniques and skilled employees.

The outstanding people in our team perform their work with enormous experience, a deep understanding of the customer and great dedication.

In addition, we are thrilled to cooperate with our British partner Bill Dixon. Working closely with our in-house experts, the award-winning designer is creating a new range of innovative Sealine models.

Above all, we believe that what holds true for the experienced boater, also holds true for us as boat builders. Beyond the individual skill, there is something which genuinely binds all of us at Sealine: A great passion for the sea.



DROP ANCHOR AT SEALINE

YOUR LOCAL SEALINE DEALER IS LOOKING FORWARD TO YOUR VISIT.

SEALINE C330v





C330



C330v



S330



S330v



C390



C390v



C430



F430



C530



F530



www.sealine.com

Sealine Ladebower Chaussee 11 D-17493 Greifswald